

# Todorich Illuminated Depressor

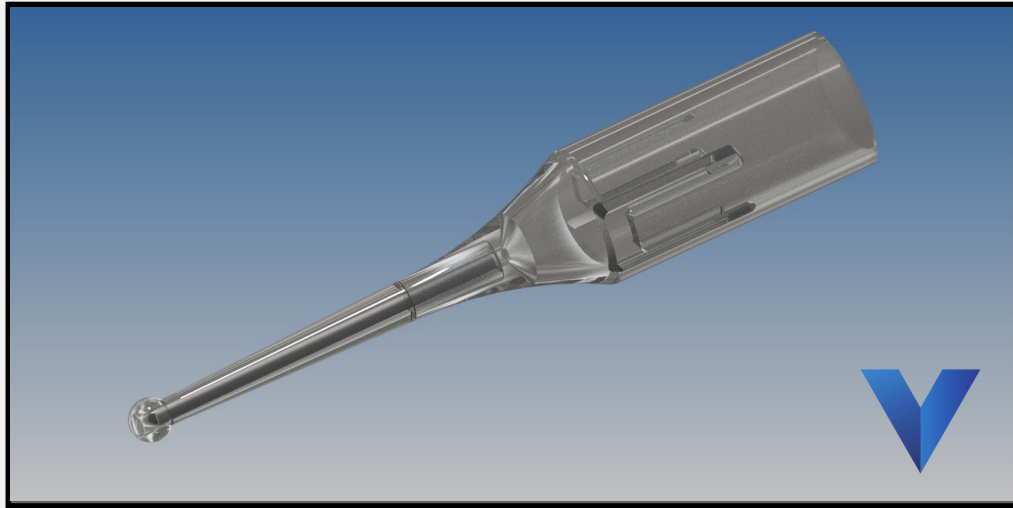

- ◆ *A conventional ball-point depressor with transscleral illumination powered by your Alcon light pipe*
- ◆ *The device is designed to allow the surgeon to simultaneously perform unassisted scleral depression while shaving the vitreous base*
- ◆ *It is compatible with 23g, 25g and 27g Alcon Constellation Light Pipes*
- ◆ *Part number: VS0800, 5/box, sterile*

Developed in collaboration with Bozho Todorich, M.D., Ph.D.



[www.vortexasurgical.com](http://www.vortexasurgical.com)

**636.778.4350**

[info@vortexasurgical.com](mailto:info@vortexasurgical.com)

\*Trademarks are property of their respective owners